

Contractor's Mechanical Grapple

Allied's demolition and material/waste handling system



The Contractor's Mechanical Grapple—designed to excel in severe, heavy-duty demolition and material /waste handling applications.

Allied earned its reputation with engineering that works and equipment that lasts. The Allied Contractor's Mechanical Grapple continues that tradition with a design strength that is unparalleled in the industry as it can withstand the full breakout force of the excavator on a single tine.

Key features are:

- Thicker exterior plates
- Both upper and lower jaws feature thicker, stronger lugs
- Completely reinforced internally
- Connection between stiff arm and lower jaw is stronger by design
- Heavy-duty mounting pad design

Pin-and-boss kits are available for all common carriers which provides greater interchangeability from machine to machine in the same weight class. Allied offers Contractor's Mechanical Grapples for excavators ranging from 25,000 to 155,000 pounds.

The Allied Contractor's Mechanical Grapple provides denser loading capabilities. The wear tips of the fully-closed grapple create a large, flat surface for improved compaction of the loaded material.

Grapples are used in all types of material handling, demolition and dismantling operations. The Allied Contractor's Mechanical Grapple is mounted in place of the excavator bucket and operates off the bucket cylinder with no additional hydraulic requirements. Once mounted, the Contractor's Mechanical Grapple becomes an extension of the excavator that allows the operator to:

- Rip and tear down structures in a controlled environment
- Pick and place materials precisely
- Sort and separate materials
- Load materials especially bulky materials fast and efficiently

The fully versatile Allied Contractor's Mechanical Grapple provides performance, production and profits in a wide-range of applications and operations:

- Scrap yards (outperform magnets 3 to 1)
- Recycling facilities (easily sort and separate material **and** quickly load crushers or shredders)
- Demolition (residential, commercial and industrial demolition is easier and safer)
- Land clearing (tree stumps can be extracted quickly)
- Reconstruction (no need for cable-and-sling as large, bulky objects are moved easily)
- Rock handling (precisely pick and place rip-rap and load shot rock without damaging your haul truck)

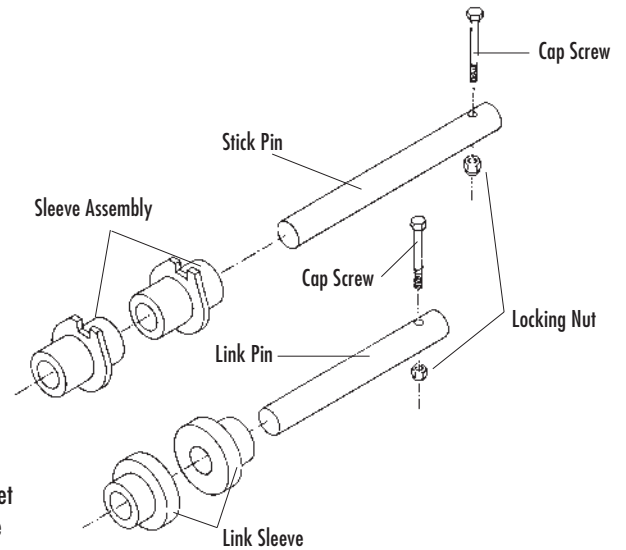

Contractor's Mechanical Grapple Specifications

Model		ABG 30B-2	ABG 40B-2	ABG 50B-2	ABG 70B-2	ABG 90B-2	ABG 140B-2
Jaw Open	(in.)	72	82	91	99	107	140
Jaw Closed	(in.)	9	10.6	12.1	11.3	12	17.5
Height	(in.)	43	49	54	59	64	82
Weight	(lbs.)	1,920	2,630	3,600	4,250	5,500	9,450
Upper Jaw Width	(in.)	23.0	30.0	30.0	32.0	34.0	35.5
Lower Jaw Width	(in.)	34.5	44.0	44.0	48.0	51.5	60.0
Upper Jaw Tine Width	(in.)	5.9	7.5	7.5	8.1	8.7	10.0
Lower Jaw Outer Tine Width	(in.)	4.3	5.5	5.5	5.9	7.17	10.0
Lower Jaw Center Tine Width	(in.)	6.0	7.5	7.5	8.1	8.7	10.0
Minimum Carrier Weight	(lbs.)	25,000	35,000	45,000	65,000	85,000	135,000
Maximum Carrier Weight	(lbs.)	35,000	45,000	65,000	85,000	135,000	155,000

Model Identification Example: ABG 90B-2 A= Allied/B=Box Type Construction/
G=Grapple/90B=90,000# Excavator/2=Number of Tines on Upper Jaw



For sales and service, contact your Allied Distributor:



3900 Kelley Avenue, Cleveland, Ohio 44114
Tel: 216-431-2600 Fax: 216-431-2601
e-mail: Sales@AlliedCP.com
website: <http://www.AlliedCP.com>